

788059  
311-2600R

- 80 - 20W-50 OIL
- 100 - SEALANT
- 134 - SEAL KIT

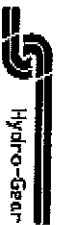
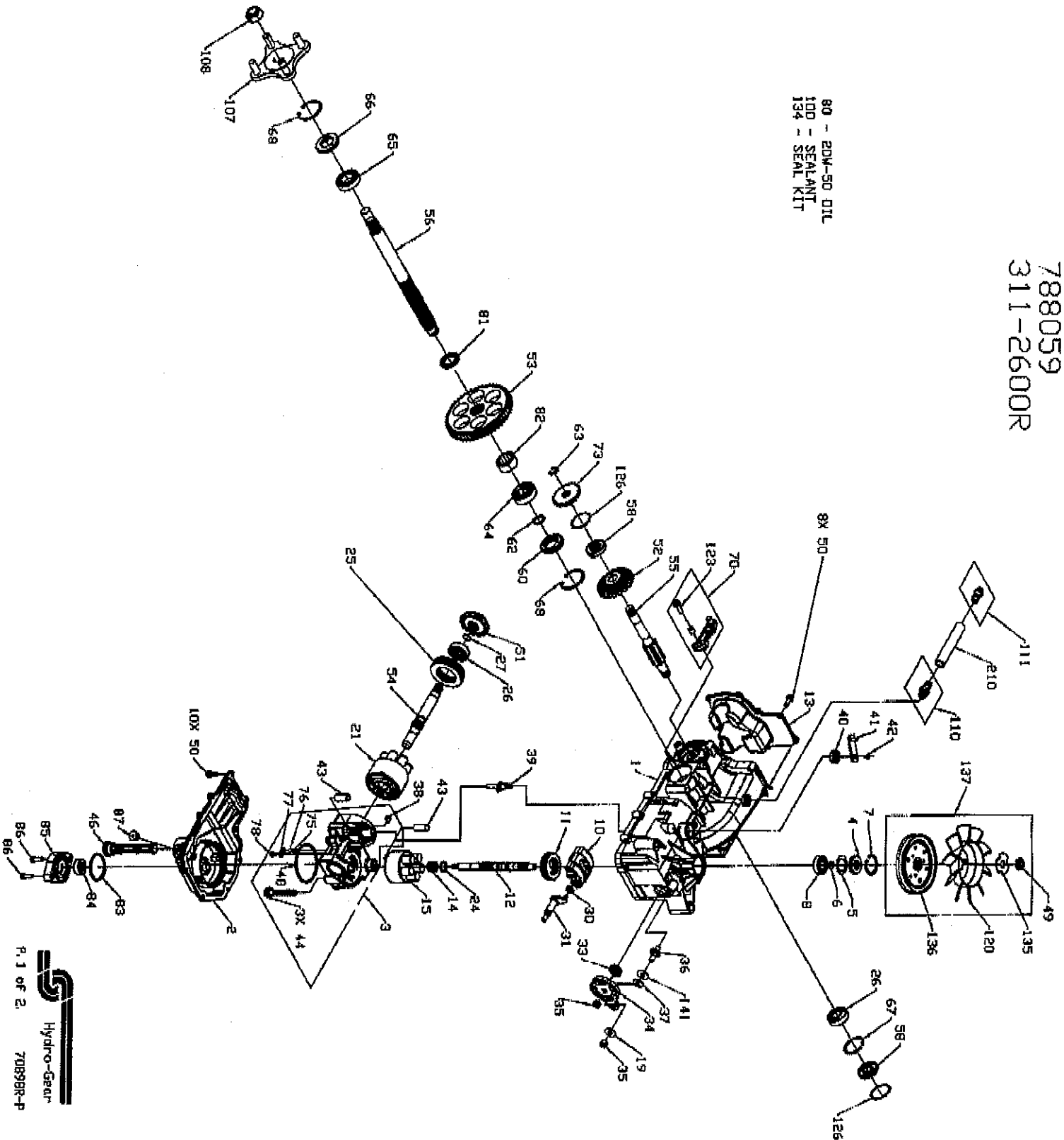

788059  
311-2600R

ITEM #	PART #	QTY	DESCRIPTION
1	70652	1	KIT, HOUSING-MAIN
2	51772	2	COARSE BEARING
3	70903	1	INNER HOUSING
4	9008000-0128	1	SEAL, LIP 12 X .25 X 7
5	2003018	1	SCREEN, FTNC 1/4-28 X 7/8 (PATENT)
6	2003016	1	WASHER .34 X .88 X .03
7	2003052	1	LOWER HOUSING
8	2003043	1	KIT, CENTER SECTION
9	2003087	1	CENTER SECTION
10	50551	1	BRUSHING .673 X 1.03 X .75
11	51771	1	PLATE, BYPASS
12	50891RM	1	FRNG, 3/8-24 X 2.5 (PATCH)
13	2003014	1	ASSEMBLY, SHOCK VALVE .027
14	70331	1	BALL 1/4
15		1	O-RING, 139 X 2.984 X 7
16		1	PLATE, HELIOT
17		1	BEIT, SELF-TAPPING 10-32 X .5
18		1	LIP SEAL
19	44130	1	SPACER
20	70082	1	WIRE RETAINING RING
21		1	RETAINING RING
22		1	BALL BEARING
23		1	VARIABLE SWASHPATE
24		1	THRUST BEARING 30 X 32 X 13
25		1	SHAFT, INPUT
26		1	CHEER-BACK
27		1	SPRING, BLDC
28		1	10CC CYLINDER BLDC ASS'Y
29		1	10CC CYLINDER BLDC
30		1	10CC PISTON SPRING
31		1	PISTON SEAT WASHER
32		1	WASHER
33		1	21CC CYLINDER BLDC ASS'Y
34		1	21CC CYLINDER BLDC
35		1	21CC PISTON SPRING
36		1	PISTON SEAT WASHER
37		1	21CC PISTON
38		1	WASHER, BLACK THRUST
39		1	THRUST BEARING 42 X 68 X 16
40		1	BALL BEARING
41		1	WIRE RETAINING RING
42		1	SLOT GUIDE
43		1	TRIPLANET ARM
44		1	CENTRAL ARM
45		1	NUT
46		1	STUD - SHORT 5/16-24
47		1	FRICTION PUCK
48		1	KIT, BYPASS PLATE
49		1	BYPASS ACTUATOR
50		1	LIP SEAL
51		1	BYPASS ARM
52		1	RETAINING RING
53		1	RETAINING RING
54		1	SCREW
55		1	ASSEMBLY, FILTER
56		1	HEX LOCK NUT 1/2-20 (NOMEN INSERT)
57		1	SCREW, 1/4-20 X .75 (NOMEN INSERT)
58		1	1/2 BEVEL GEAR
59		1	1/2 BEVEL GEAR
60		1	1/2 BEVEL GEAR
61		1	1/2 BEVEL GEAR
62		1	1/2 BEVEL GEAR
63		1	1/2 BEVEL GEAR
64		1	1/2 BEVEL GEAR
65		1	1/2 BEVEL GEAR
66		1	1/2 BEVEL GEAR
67		1	1/2 BEVEL GEAR
68		1	1/2 BEVEL GEAR
69		1	1/2 BEVEL GEAR
70		1	1/2 BEVEL GEAR

ITEM #	PART #	QTY	DESCRIPTION
54	50757	1	HOUSING SHAFT
55	51298	1	BRAKE SHAFT
56	50748	1	AXLE SHAFT
58	51161	2	SEAL, LIP 17 X 40 X 7
60	50995	1	SEAL RING - SIDE
62	50739	1	RETAINING RING - AXLE
63	51109	1	RETAINING RING
64	50743	1	BEARING-BALL 2047X14(6200)
65	50740	1	BEARING-BALL 2347X12(6005)
66	50751	1	SEAL
67	50329	1	RETAINING RING
68	50760	2	RETAINING RING-AXLE
70	70392	1	RH, BRAKE ARM SERVICE ASSEMBLY
		1	BRAKE ARM
		1	CLEVIS PIN
		1	BRUSHING .255 X .381 X .330
		1	SCREEN, FTNC 1/4-28 X 7/8 (PATENT)
		1	BRAKE DISC
		1	2W-30 OIL
73	50754	1	AXLE WASHING
80	50942-2	1	AXLE WASHING
81	50942-1	1	AXLE WASHING
82	5004101-1340	1	O-RING, 105 X 1.862
83	50273	1	ASSEMBLY, GEROTOR
84	50260	1	CORER, GEROTOR
85	50095	1	SPCS 16 X 20
86	50095	1	PLUG, 9/16-18 (MTRAL)
87	9005110-5600	1	SEAL/NUT
100	50928	1	SEAL/NUT
107	70314	1	HAIR ASSEMBLY
		1	HAIR
		1	LUB NOIL
		1	NUT, HEX 3/4-16
		1	FITTING, B-RING ASSEMBLY
		1	PLASTIC HOSE FITTING
		1	O-RING, 88 X .468
		1	CP VENT ASSEMBLY
		1	CP-POPEE VALVE
		1	ST .5 BARB VENT
		1	PAILEY, 4.5
		1	SCREEN, FTNC 1/4-28 X 7/8 (PATENT)
		1	RING, RETAINING
		1	KIT, SEAL
		1	SEAL, LIP 15 X 35 X 7
		1	RING, RETAINING 37 INT
		1	SEAL, LIP 12 X 25 X 7
		1	SEAL, LIP 10 X 25 X 7
		1	RING, RETAINING .31 EXT
		1	HTKS 1/4-20 X .75
		1	SEAL PLUG
		1	RING, RETAINING .75 EXT
		1	RING, RETAINING .440 EXT
		1	SEAL, LIP 25 X 47 X 7
		1	RING, RETAINING 1.56 INT
		1	RING, RETAINING 1.87 INT
		1	RING, RETAINING 1.43
		1	WASHER, DR SLOTTED .53 X 1.53 X .06
		1	FAN, 5", 10 BLADE
		1	KIT, FAN-PAILEY
		1	WASHER, DR SLOTTED .53 X 1.53 X .06
		1	FAN, 5", 10 BLADE
		1	HEX LOCK NUT 1/2-20 (NOMEN INSERT)
		1	PAILEY, 4.5
		1	WASHER .34 X .88 X .03
		1	NUT 1/2 X 1.00